

1987 REPAIR MANUAL

Shimano American Corporation, One Shimano Dr.
 Irvine, CA 92718

TO ORDER:

This reel belongs to the "Rear Drag" series.
 Please order parts using the abbreviation
 "RD" and the part number.

※ Please look here for "S" mark here
 (e.g. 87 S KB - JAPAN)

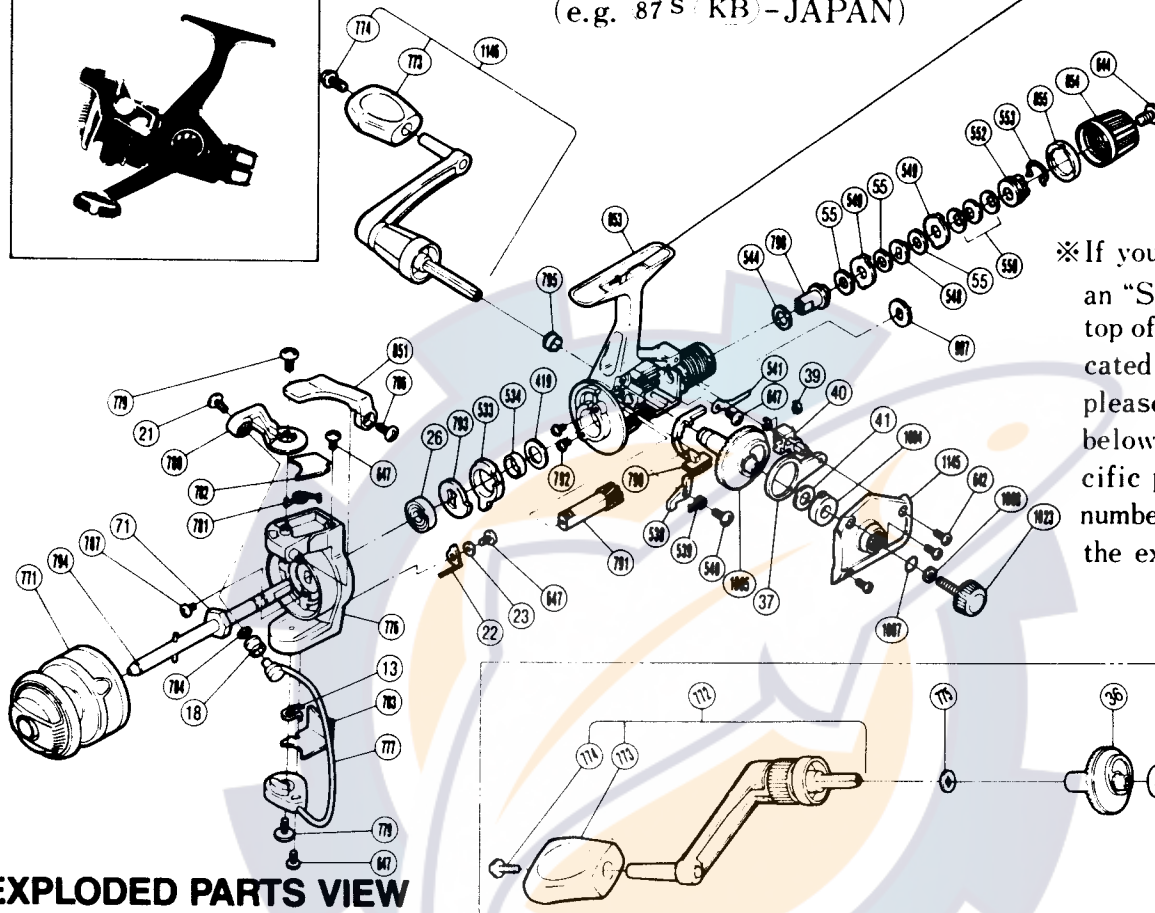
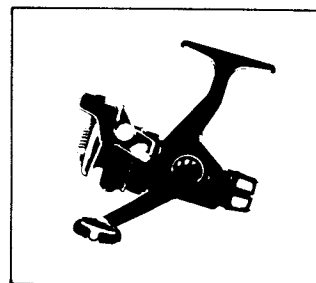

※ If your reel does not have
 an "S" mark molded on the
 top of the reel foot as indi-
 cated in the exploded view,
 please use the parts view
 below to order these spe-
 cific parts. All other parts
 numbers are as shown in
 the exploded view.

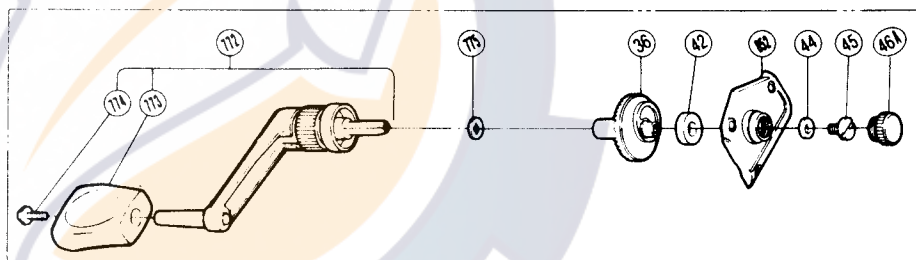

EXPLODED PARTS VIEW

AX100

PARTS LIST

PART # DESCRIPTION

- 13. Lever Spring
- 18. Line Roller
- 22. Bail Trip Lever
- 23. Trip Lever Spacer
- 26. Ball Bearing
- 36. Drive Gear
- 37. Oscillating Arm
- 39. "C" Lock
- 40. Oscillating Block
- 41. Drive Gear Washer
- 42. Bushing A
- 44. Handle Lock Washer
- 45. Handle Lock Screw
 (Originally 796)
- 46A. Handle Screw Cap
- 55. Drag Washer "C,"
- 71. Rotor Nut
- 419. Bushing Washer
- 533. Anti-Reverse Lock Out
- 534. Pinion Spacer
- 538. Anti-Reverse Pawl
- 539. Anti-Reverse Pawl Spring
- 540. Anti-Reverse Pawl Screw
- 541. Drag Click
- 544. Drag Washer "C₂"

PART # DESCRIPTION

- 548. Key Washer "A"
- 549. Eared Washer "B"
- 550. Coned Disc Springs
- 552. Pressure Screw
- 553. Hold Click Spring
- 642. Side Cover Screw
- 644. Drag Knob Screw
- 647. Multi Purpose Screw
- 771. Spool Assembly (Universal)
- 772. Handle
- 773. Handle Knob
- 774. Handle Knob Screw
- 775. Handle Lock Spacer
- 776. Rotor
- 777. Bail Assembly
- 778. Line Roller Screw
- 779. Bail Trip Cam Screw
- 780. Bail Arm
- 781. Bail Spring
- 782. Bail Spring Cover
- 783. Bail Trip Cover
- 784. Line Roller Washer
- 786. Trigger Screw
- 787. Nut Lock Screw
- 790. Anti-Reverse Switch

PART # DESCRIPTION

- 791. Pinion Gear
- 792. Multi Purpose Screw
- 793. Anti-Reverse Ratchet
- 794. Main Shaft
- 795. Bushing B
- 798. Drag Shaft
- 851. Quick-Fire II Trigger
- 852. Side Cover
- 853. Body
- 854. Drag Knob
- 855. Knob Spacer
- 997. Click Gear
- 1004. Bushing A ("S" Version)
- 1005. Drive Gear ("S" Version)
- 1007. Lock Washer Retainer
 ("S" Version)
- 1008. Handle Lock Washer
 ("S" Version)
- 1023. Handle Screw Cap
 ("S" Version)
- 1145. Side Cover ("S" Version)
- 1146. Handle Assembly
 ("S" Version)